

EXTERNAL LIGHTING IS A VERY IMPORTANT ASPECT OF COMMUNITY SAFETY AND CRIME PREVENTION. THE PERFORMANCE CRITERIA WHICH HAS BEEN CONSIDERED FOR THE EXTERNAL ROADWAY AND PEDESTRIAN AREA LIGHTING DESIGN ASSOCIATED WITH THIS DEVELOPMENT INCLUDES FACILITATION OF SAFE MOVEMENT, THE DISCOURAGEMENT OF ILLEGAL ACTS, THE VISUAL REQUIREMENTS FOR THE VEHICULAR AND PEDESTRIAN ACTIVITIES. EXTERNAL CAR PARK, ROAD RESERVE AND PATHWAY LIGHTING HAS BEEN DESIGNED TO MEET THE RELEVANT REQUIREMENTS OF:

- CRIME PREVENTION THROUGH ENVIRONMENT DESIGN GENERAL CODE (MARCH 2008)
- AS 4282:1997 CONTROL OF THE OBTRUSIVE EFFECTS OF OUTDOOR LIGHTING
- AS/NZS 1158.3.1:2005 AND AS/NZS1680.2.1 FOR THE FOLLOWING CATEGORIES:
- NCA DEVELOPMENT CONTROL PLAN FOR BLOCKS 4 & 5 SECTION 38 CAMPBELL LIGHTING STRATEGY

HATCHING	LIGHTING CATEGORY	PEDESTRIAN ACTIVITY	RISK OF CRIME	NEED TO ENHANCE PRESTIGE
	AS/NZS 1680.2.1:2008 (APPENDIX D1, ITEM 11)	N/A	N/A	N/A
	AS/NZS 1158.3.1:2005 CATEGORY P3	MEDIUM	LOW	MEDIUM
	AS/NZS 1158.3.1:2005 CATEGORY P4	LOW	LOW	N/A
	AS/NZS 1158.3.1:2005 CATEGORY P1c	LOW	LOW	*

* NIGHT TIME OCCUPANCY RATE <25%.

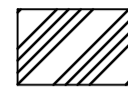
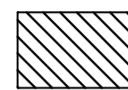
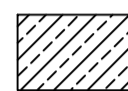
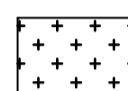
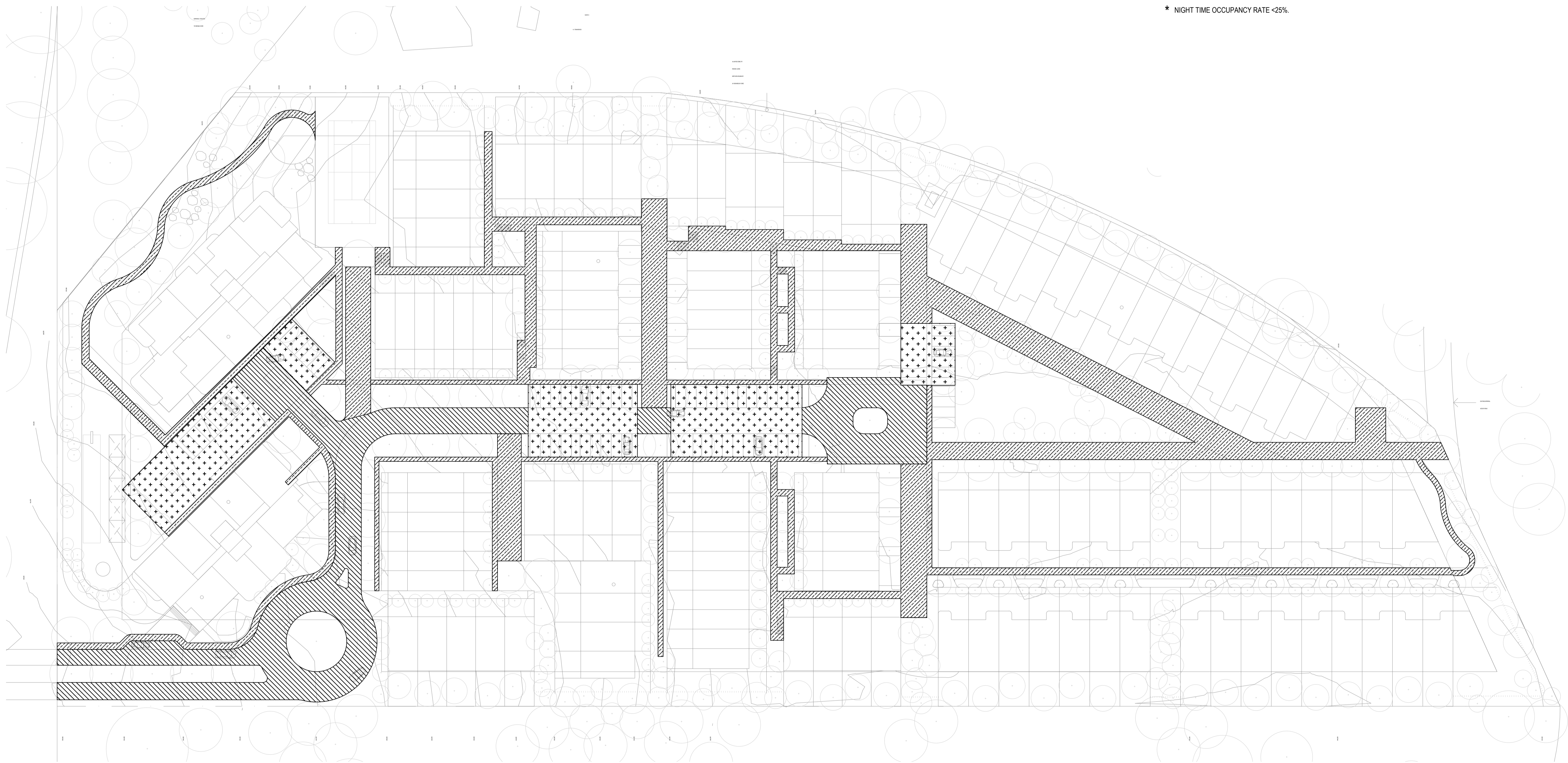

Rev.	Date	Details and Status	By	Rev.	Date	Details and Status	By
03	22.05.19	REISSUE FOR CONCEPT DESIGN - REV B	JT				
02	22.01.19	REISSUE FOR CONCEPT DESIGN	JT				
01	24.08.18	ISSUE FOR CONCEPT DESIGN	DO				

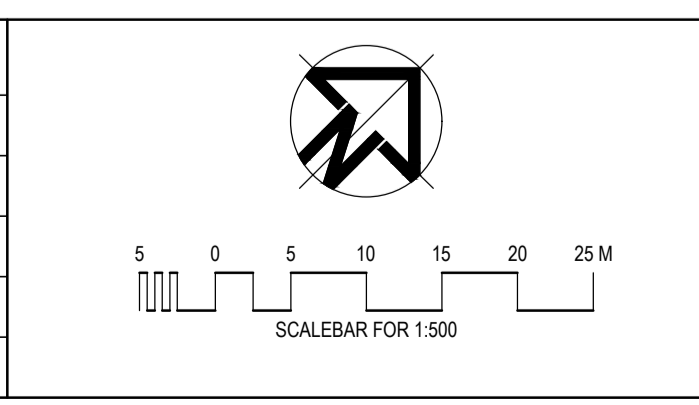

NOT FOR TENDER

©COPYRIGHT RUDDS CONSULTING ENGINEERS PTY LTD (DATE OF ISSUE). REPRODUCTION OF THE WHOLE OR PART OF THE DOCUMENT CONSTITUTES AN INFRINGEMENT OF COPYRIGHT. THE INFORMATION, IDEAS AND CONCEPTS CONTAINED IN THIS DOCUMENT ARE CONFIDENTIAL. THE RECIPIENT(S) OF THIS DOCUMENT IS/ARE PROHIBITED FROM DISCLOSING SUCH INFORMATION, IDEAS AND CONCEPTS TO ANY PERSON WITHOUT THE PRIOR WRITTEN CONSENT OF THE COPYRIGHT HOLDER

Rudds Consulting Engineers
PTV LIMITED
 ABRN 16 056 221 162

5 Bodalla Place
 Fyshwick, ACT 2609
 Tel: (02) 6240 2900
 Fax: (02) 6280 9951
 Email: firstname.surname@rudds.com.au
 Website: www.rudds.com.au

Designed P. McKenzie	Reviewed / Date L. Forner 22.05.19	Approved / Date L. Forner 22.05.19
Drawn J. Thilakasi	AutoCAD Drawing 118410-E120 [03]	

Client

DOMA

Project

**CAMPBELL,
SECTION 38, BLOCK 4 AND 5**

Drawing Title SITE PLAN - EXTERNAL LIGHTING CATEGORIES ELECTRICAL SERVICES			
Scale 1:500	Sheet Size A1	Drawing No. 118410-E120	Rev. 03